

Magnetic Absolute Encoder

Multi & Single Turn

- No Bearings
- No Moving Discs
- Sine Cosine Technology
- Encapsulated Electronics



Specifications	Multi-Turn	Single Turn
Max speed of shaft	6000 RPM	500 RPM
Acceleration of shaft from zero RPM Power off	100 rad/S ₂	100 rad/S ₂
Maximum Turns	52400	Not Used
Resolution	5 angle degrees	0.5 angle degrees
Pulse Output (Speed Detection)	4 pulses/rev—open collector	Not Used
Data Communication	RS485 serial Bidirectional Master & Slave 19200 Baud (Encoder=Slave)	
Supply Voltage	10—15 VDC	
Storage Temperature	-20 to +60° C	
Battery Temperature	-20 to +60° C	
Enclosure	ABS or Molded (Macromelt)	
EMC Compliance	EN61000-6-2, EN61000-6-4	

Serial Communication Specifications

- Encoder waits for request and will answer if the request is identified and correct.
- Baud rate is 19200, no parity bit
- Min. request time—6.3 msec (between 2 requests)
- Response message is 5 bytes where the last byte is the XOR checksum of the first 4

Communication Messages

- A0hex is request for position
- A5hex is request for actual battery voltage
(4.7mV/unit, Example: 3.6V=766, min value is 660=3.1 volts)
- A7hex is request for battery alarm
(respond: 0=OK, 1=low battery)
- A8hex is reset of battery alarm

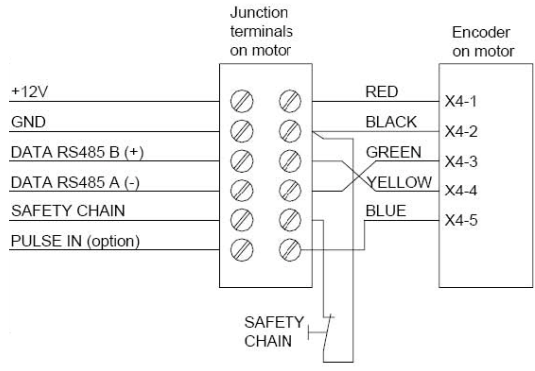
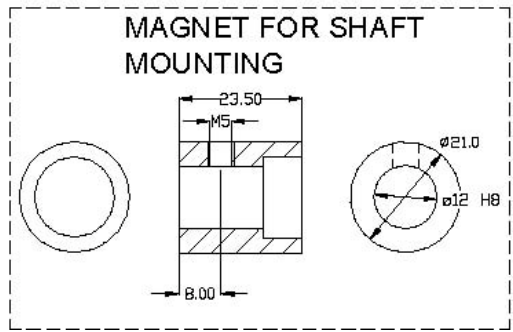
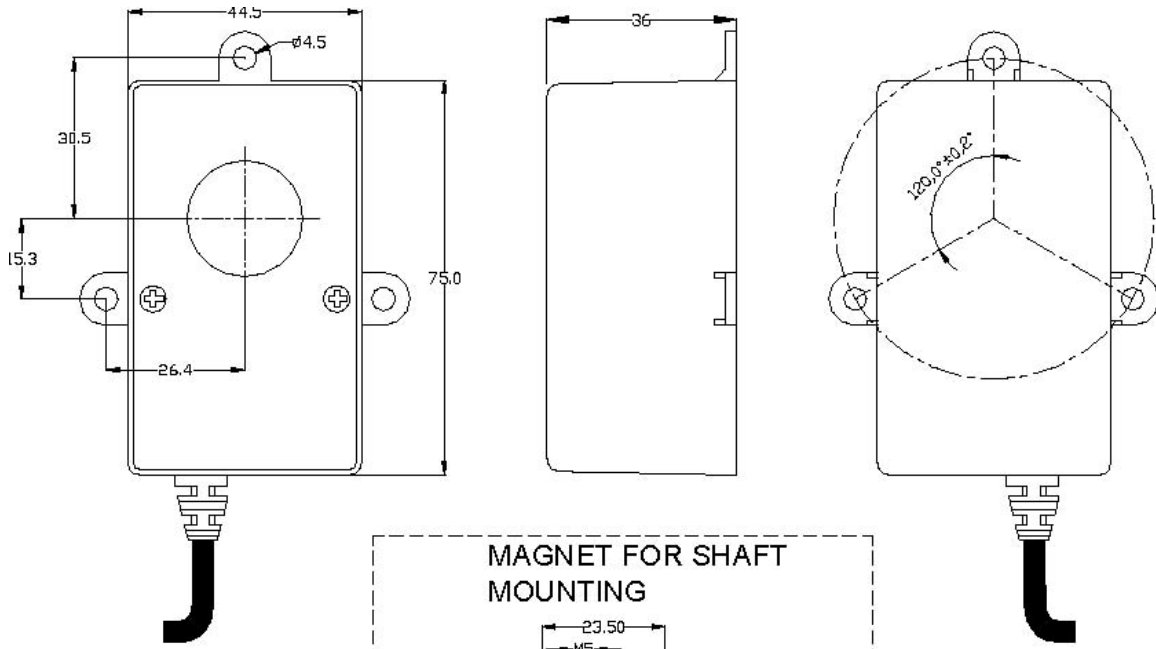

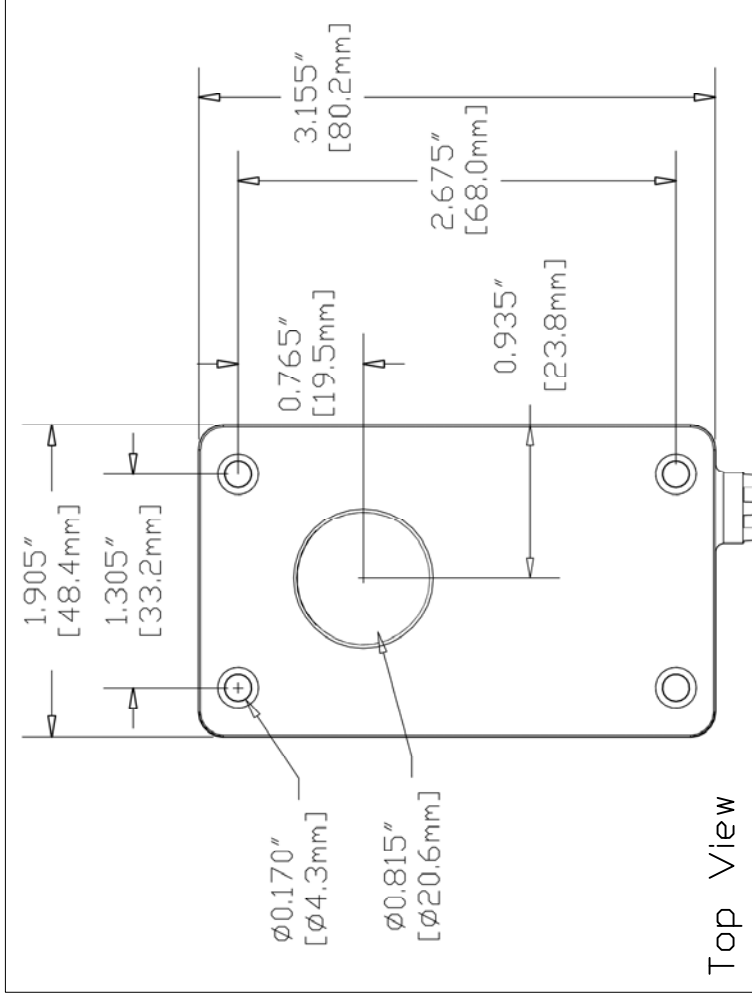

Top View

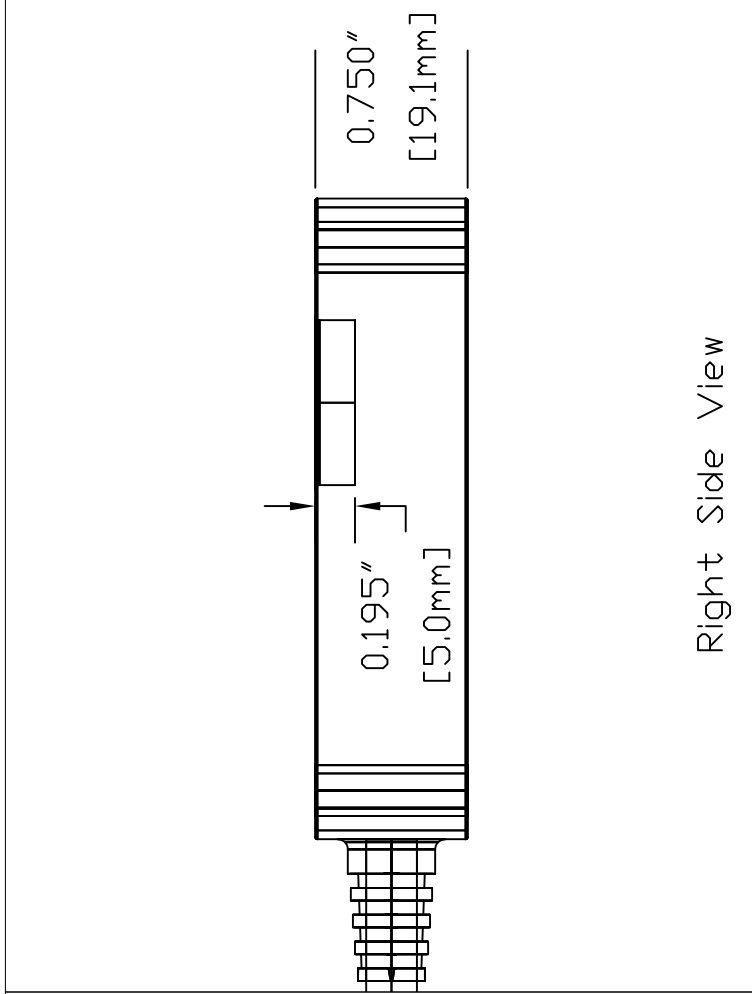

Right Side View

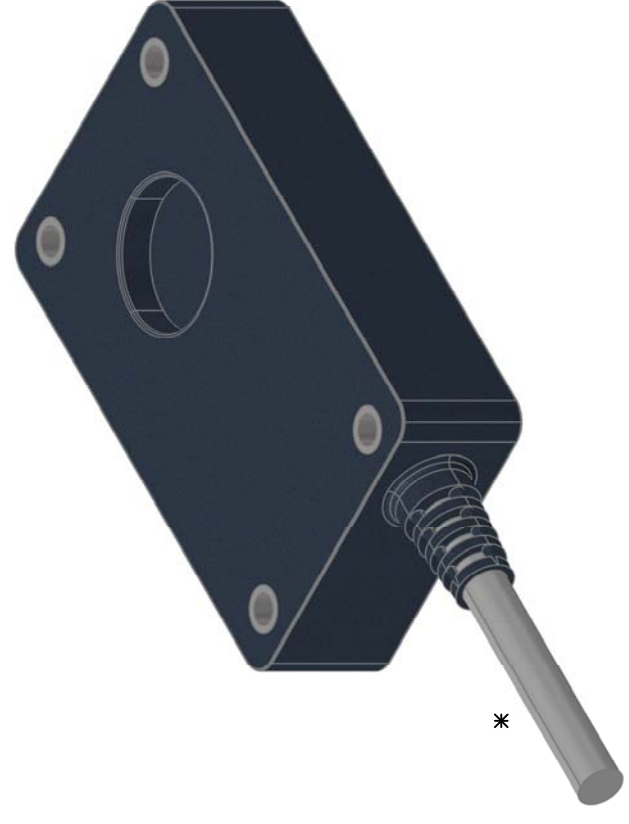

SW Isometric View

*Specify cable length upon ordering.